



Item # _____

RDCO Countertop Convection Oven



RDCO-1

STANDARD FEATURES:

- ◆ Compact Design - Easily installed on a counter or shelf of an equipment stand.
- ◆ Heavy gauge stainless steel welded front frame.
- ◆ Heavy Duty Base, Standard 4" adjustable legs.
- ◆ High performance capacity accommodates a single full size sheet pan and offers two rack positions.
- ◆ Electronic Ignition System - No standing pilot; provides 100% safety. Burner "ON" Indicator light.
- ◆ Stainless Steel Oven Interior - For durability and ease in cleaning.
- ◆ Drop down door with counterbalance
- ◆ Single, sheet metal "U" tube burner rated at 16,000 BTU per hour designed to provide maximum efficiency and ensure even heat distribution. Fast heat up and recovery.
- ◆ Electric Thermostat - Adjustable from 150° to 500°F. Sensing bulb is positioned inside the oven cavity for accurate temperature control.

OPTIONS:

- ◆ Optional Stacking Kit - Creates a space saving two oven system.

The Royal thermostatically controlled Convection Oven is designed to do the job of a full-sized Convection Oven. It quickly and evenly cooks breads, pastry, croissants, cookies, fish, lobster, steak and much more. This compact Convection Oven is designed to be installed on either a countertop, optional stand or shelf.

Built for versatility, it easily accommodates a full-size sheet pan with two rack positions. An optional kit allows to ovens to be stacked. Like all Royal Range gas cooking equipment this oven incorporates a tradition of quality, engineering and value.



Specifications RDCO Countertop Convection Oven

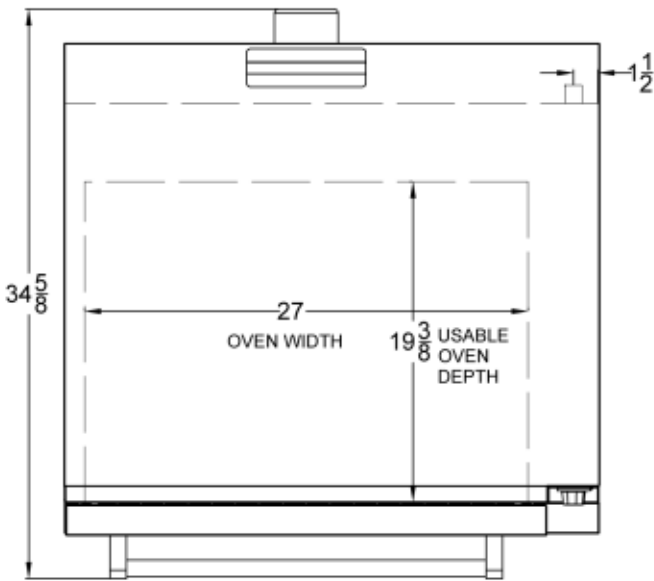
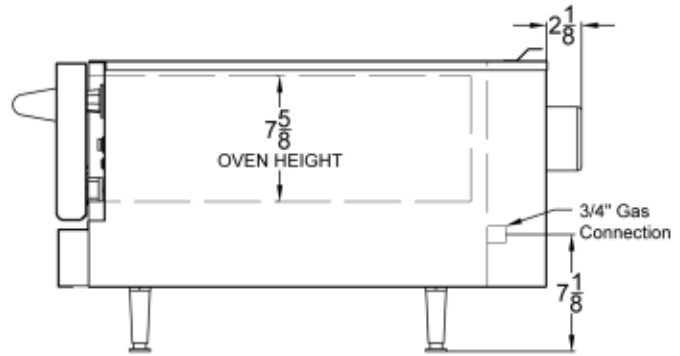
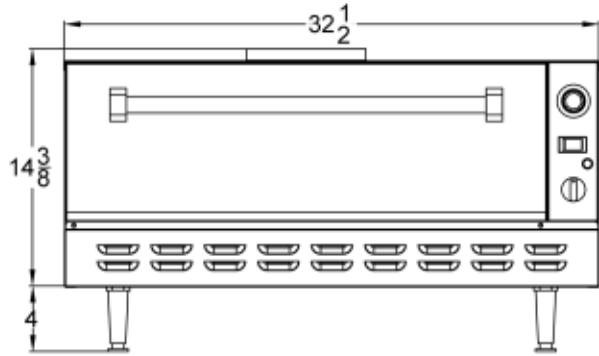

MODEL	WIDTH	DEPTH	NUMBER OF BURNERS	TOTAL BTU	SHIP WEIGHT
RDCO-1	32-1/2"	34-5/8"	1	16,000	190 Lbs

Electrical requirements: 120 VAC, 60Hz, 1Ph, 2.5A
 Provided with 6' power cord fitted with a standard three prong grounded plug.

Gas Connection: 3/4" NPT on the right hand rear of the appliance
 The pressure regulator (supplied) is to be connected here by the installer.

Gas pressure: 5" W.C. - Natural Gas
 10" W.C. - Propane

Combustible Clearances:
 6 inches sides
 6 inches rear

Non-combustible Clearances:
 0 inches sides
 0 inches rear

Specify type of gas and altitude, if over 2,000 feet, when ordering.

Due to continuing product development to ensure best possible performance, these specifications are subject to change without prior notification

3245 CORRIDOR DR. MIRA LOMA, CA. 91752 951.360.1600 FAX 951.360.7500 (01/09)